

BK 39 Pg 37

CORNER RECORD

Document Number CR 4436

City of OAKLAND

County of ALAMEDA, California

Brief Legal Description IRON PIN MONUMENT LOCATED WITHIN THE INTERSECTION OF E.33RD STREET AND 14TH AVENUE. (14NW10)

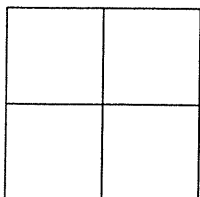

CORNER RECORD

Government Corner ☐ Control ☒
Meander ☐ Property ☐
Rancho ☐ Other ☐
Date of Survey 1/19/11

COORDINATES
(Optional)

N. _____
E. _____
Zone _____ Datum _____
Elev. _____

Corner — Left as found ☒ Found and tagged ☐ Established ☐ Reestablished ☐ Rebuilt ☐

Identification and type of corner found: Evidence used to identify or procedure used to establish or reestablish the corner:
FOUND IRON PIN MONUMENT LOCATED WITHIN THE INTERSECTION OF E.33RD STREET AND
AND BEAUMONT AVENUE.

AS SHOWN ON CITY OF OAKLAND MONUMENT MAP, PAGE 207.

THIS POINT WAS REFERENCED PRIOR TO A CONSTRUCTION PROJECT IN THE VICINITY.

A description of the physical condition of the monument as found and as set or reset:

FOUND AND SET POINTS AS SHOWN ON PAGE 2.

THESE TIES ARE FOR THE PURPOSE OF PERPETUATING THE FOUND MONUMENTATION.

NO CLAIM IS MADE AS TO THE RELATIONSHIP OF THE POINTS OR LINES SHOWN HEREON
TO TRUE BOUNDARY LOCATIONS.

SURVEYOR'S STATEMENT

This Corner Record was prepared by me or under my direction in conformance with

the Land Surveyors' Act on JANUARY 26, 2011.

Signed Vincent H. Cunha L.S. Number LS 4520

VINCENT H. CUNHA



COUNTY SURVEYOR'S STATEMENT

This Corner Record was received 2-7-2011 and examined

and filed 3-12-2011.

Signed Russell R. Penland, Jr. Title COUNTY SURVEYOR

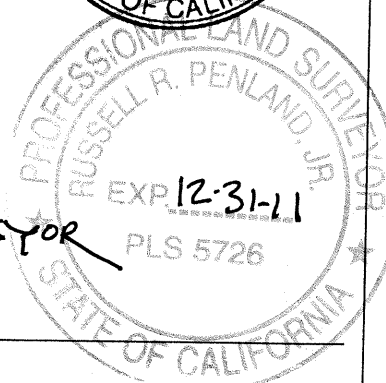

County Surveyor's Comment

STATE HIGHWAY ROUTE 580

LEGEND

● FOUND IRON PIN IN MONUMENT WELL(14NW10)

✕ FOUND NAIL AND TAG LS 4520 (PER CR4324)

JK6857 ALAMEDA COUNTY MONUMENT ID

JK6857 ALAMEDA COUNTY MONUMENT ID

MACARTHUR BOULEVARD

E.33RD STREET

BEAUMONT AVENUE

210078\33RD\CR-2