

# CORNER RECORD

Agency Index

BK 112 PG 83

Document Number

CR 11587

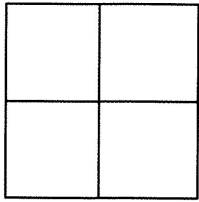
City of EDEN TOWNSHIPCounty of ALAMEDA, CaliforniaBrief Legal Description BOLT MONUMENT LOCATED WITHIN N. 3RD ST  
AT THE INTERSECTION OF CRESCENT AVE.

## CORNER TYPE

Government Corner	<input type="checkbox"/>	Control	<input checked="" type="checkbox"/>
Meander	<input type="checkbox"/>	Property	<input type="checkbox"/>
Rancho	<input type="checkbox"/>	Other	<input type="checkbox"/>

Date of Survey 6/11/18

## COORDINATES (Optional)

N. 2074191 E. 6104463

Elevation \_\_\_\_\_

Units Metric ☐ U.S. Survey Foot ☐

Horizontal Datum \_\_\_\_\_

Zone \_\_\_\_\_ Epoch Date \_\_\_\_\_

Vertical Datum \_\_\_\_\_

☐ Complies with Public Resources Code §§8801-8819☐ Complies with Public Resources Code §§8890-8902PLS Act Ref: ☐ 8765(d)☒ 8771☐ 8773☐ Other:Corner/Monument: ☒ Left as found☐ Established☐ Rebuilt☒ Pre-Construction☐ Found and tagged☐ Reestablished☒ Referenced☐ Post-Construction

Narrative of corner identified and monument as found, set, reset, replaced, or removed:

☐ See sheet #2 for description(s) :FOUND 1" SQUARE BOLT WITH PUNCH. MONUMENT PAVED OVER. EXCAVATED PRIOR TO REFERENCING.  
FOUND 4" BELOW GRADE.

FOUND AND SET POINTS AS SHOWN ON PAGE 2.

THIS POINT WAS REFERENCED PRIOR TO A CONSTRUCTION PROJECT IN THE VICINITY.

THE TIES SHOWN HEREON ARE FOR THE PURPOSE OF PERPETUATING FOUND MONUMENTATION.

NO CLAIM IS MADE AS TO THE RELATIONSHIP OF THE POINTS OR LINES SHOWN HEREON TO TRUE  
BOUNDARY LOCATION.

## SURVEYOR'S STATEMENT

This Corner Record was prepared by me or under my direction in conformance with

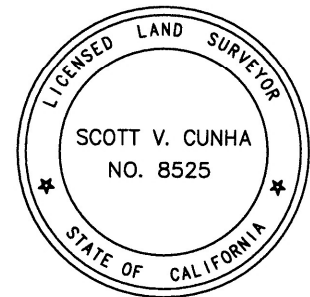
the Professional Land Surveyors' Act on JUNE 15, 2018.Signed SCOTT V. CUNHA P.L.S. or R.C.E. No. LS 8525

## COUNTY SURVEYOR'S STATEMENT

This Corner Record was received 19 JUNE 2018and examined and filed 11 SEPTEMBER 2018.Signed Michael Rubner P.L.S. or R.C.E. No. 6843Title COUNTY SURVEYOR

County Surveyor's Comment



SPEC-2355-Pre

SCALE: 1"=30'

## LEGEND

- FOUND 1" SQUARE BOLT WITH PUNCH
- ⊗ SET CUT CROSS IN WALK
- ✕ SET CUT CROSS IN CURB
- ⊗ SET MAG AND WASHER "CUNHA RP"
- SET REBAR & CAP STAMPED "CEI RP"
- AA###A# ALAMEDA COUNTY MONUMENT ID
- 19592 REFERENCE STREET ADDRESS

