

# CORNER RECORD

COUNTY OF MON T. 1S R. 28E MT. D. MERIDIAN CALIFORNIA  
 CORNER TYPE: GOV'T. CORNER ☒ MEANDER ☐ RANCHO ☐ CONTROL ☐ OTHER ☐  
 CORNER IDENTIFICATION - DATE OF VISIT NOV 3 1976



T1S  
312  
1511  
5112

CORNER - LEFT AS FOUND ☐ FOUND AND TAGGED ☐ REESTABLISHED OBLITERATED CORNER ☐ REBUILT ☒

PHYSICAL DESCRIPTION OF CORNER FOUND: EVIDENCE AND METHOD USED TO IDENTIFY OR REESTABLISH  
FOUND SE PARTS OF PINE POST 1 OF WHICH  
H. 3 IN. DIA. 14 IN. HIGH. APPEARS TO BE THE COR.  
PARTS WERE FITTED TO A HOLE IN GROUND. POST - ABOUT 21 IN. DIA.  
DUG DOWN 3' 14 IN. SE FOR OTHER POST. DUG NOT FOUND. 2 IN.  
AREA 1 IN. DIA. 14 IN. HIGH. TO BE THE COR. POST.

PHYSICAL DESCRIPTION OF MONUMENTS REBUILT OR PERPETUATED  
SET 2 1/2" DIA. 21 IN. HIGH. 1 IN. DIA. 14 IN. HIGH.  
CHP 1" DIA. 14 IN. HIGH. 2" DIA. 14 IN. HIGH.  
1 IN. DIA. 14 IN. HIGH. PARTS OF POST PLACED  
BRASS CAP STAMPED AS SHOWN ABOVE.  
MEAS. POST PLACED 3" SE'LY OF COR. PAINTED WHITE W/10 IN. DIA.

CALIFORNIA COORDINATE SYSTEM ORDER: FIRST ☐ SECOND ☐ THIRD ☐  
 STATIONS USED: NGS (USC & GS) ☒ STATE ☒ COUNTY ☐ OTHER ☐ STATION \_\_\_\_\_ STATION \_\_\_\_\_  
 ZONE 3 ELEVATION \_\_\_\_\_ NORTHINGS (Y) 506,841.08 EASTINGS (X) 2,471,389.48

SKETCH: (Include reference tie or witness points, remarks and topo of area)

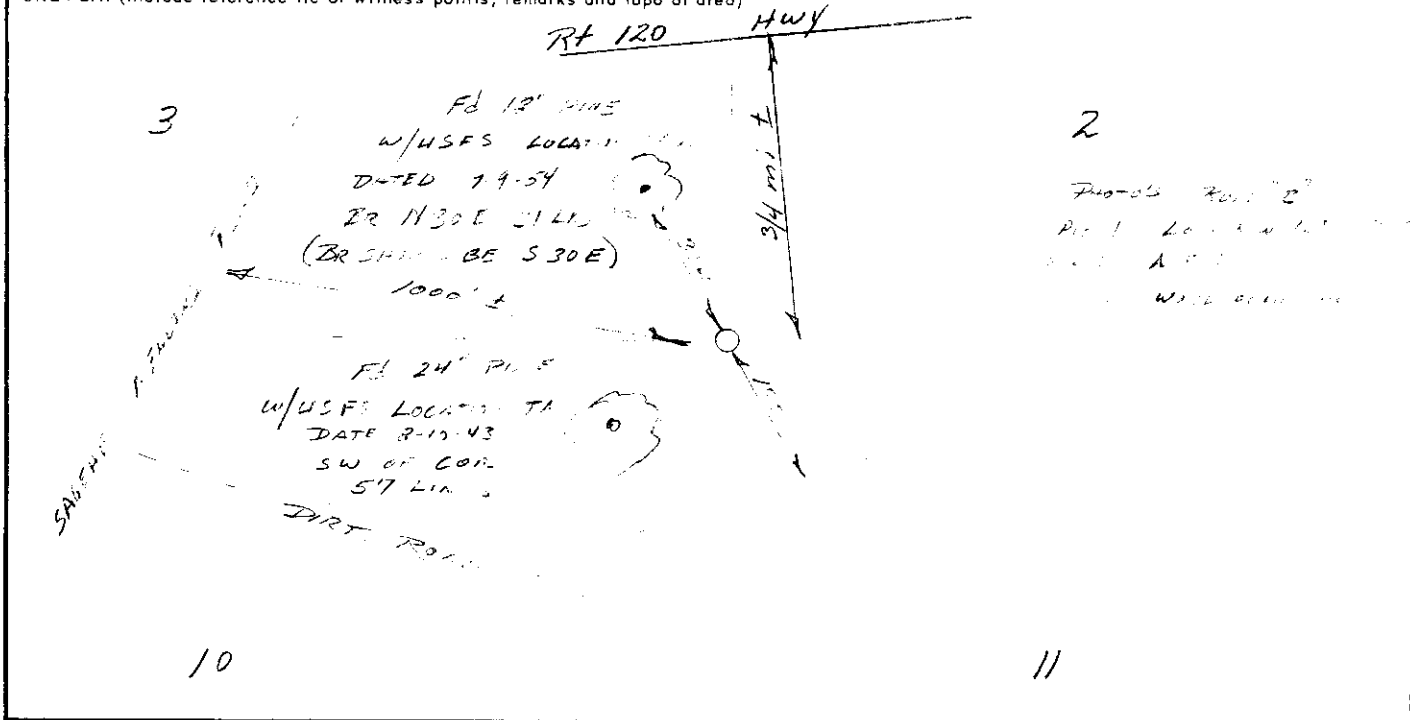

## SURVEYOR'S CERTIFICATE

THIS CORNER RECORD WAS PREPARED BY ME OR UNDER MY DIRECTION IN CONFORMANCE WITH THE LAND SURVEYORS ACT ON NOV 3 1976  
 SIGNED: [Signature]  
 L.S. or R.E. No.: 2558

SEAL

## COUNTY SURVEYOR'S CERTIFICATE

THIS CORNER RECORD WAS RECEIVED NOV 3 1976  
 AND EXAMINED AND FILED NOV 3 1976  
 BY: [Signature]  
 TITLE: [Signature]  
 DOCUMENT No. 15283-1  
 STATEMENT ON BACK OF SHEET

YES ☐ NO ☒