

\\chickfilas\2017-0181 - CFA - Revised - PLS 1/1/2020 - Design Notes - Model - ALL CAD & Drawings - Consultant\Brentford\01-16-1851-1-1.dwg Sheet No. LAYOUT -1- Revised By: James Brumfield - January 29, 2018 3:52 PM

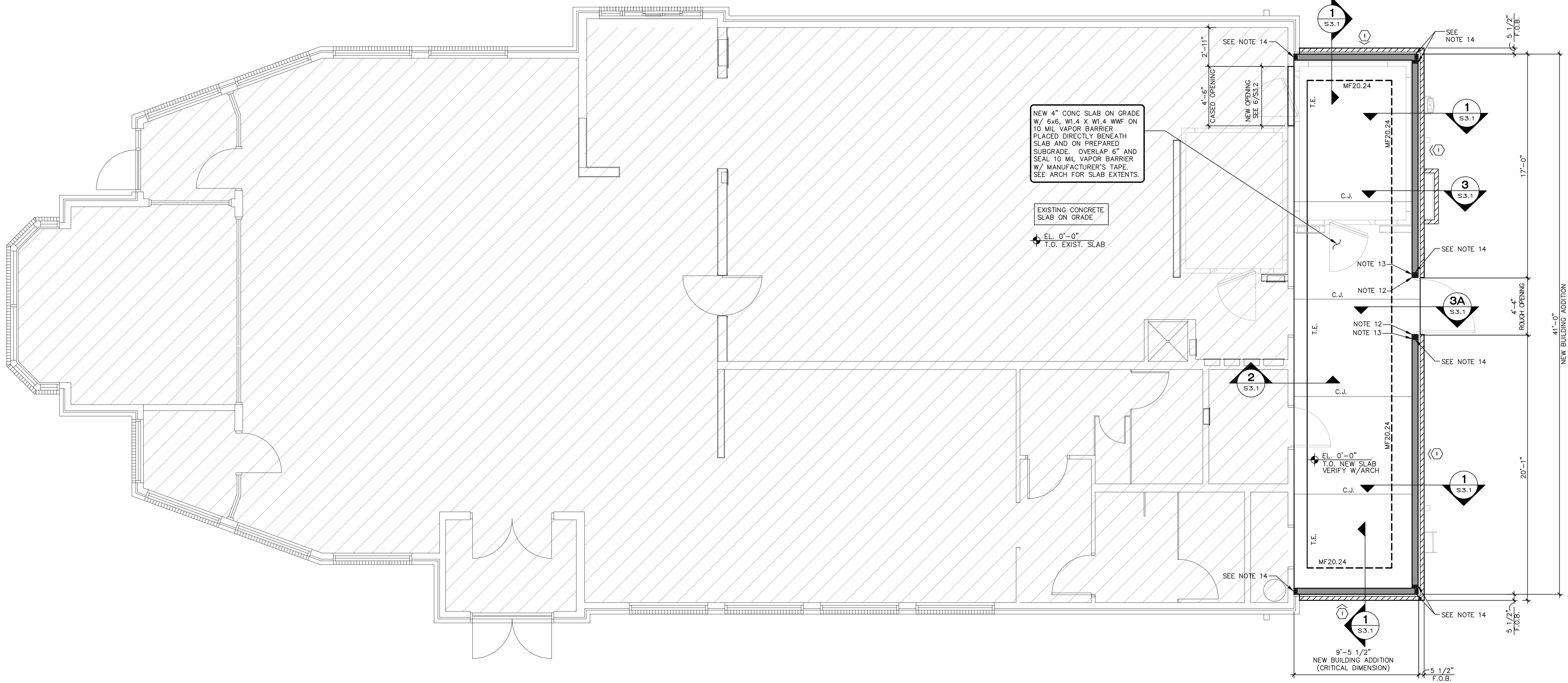

NEW PARTIAL FOUNDATION PLAN

1/4" = 1'-0"

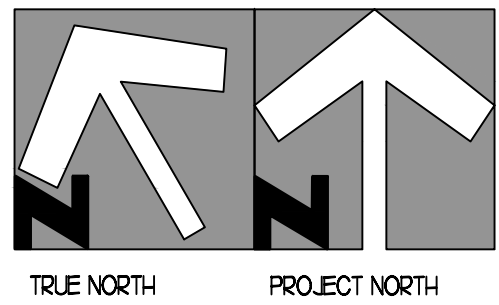

SHORING NOTE:
THE GENERAL CONTRACTOR SHALL PROVIDE SHORING FOR EXISTING ROOF FRAMING MEMBERS PRIOR TO REMOVAL OF EXISTING SUPPORTS. SHORING SHALL REMAIN IN PLACE UNTIL ALL NEW STRUCTURAL SUPPORTS ARE INSTALLED.

FOOTING SCHEDULE		
MARK	SIZE	REINFORCING
MF20.24	2'-0" W X 24" (MIN.) DEEP X CONT.	(3)#5 CONT., (1)TOP & (2)BOTT.

FOUNDATION NOTES:

- 1.) TOP OF SLAB = 0'-0". 0'-0" IS FOR REFERENCE ONLY. SEE CIVIL FOR NGVD ELEVATION.
- 2.) MFXX DENOTES MONOLITHIC CONC. FOOTING TYPE, SEE SCHEDULE THIS SHEET, VERIFY ALL BOTTOM OF FOOTING ELEVATIONS W/ CIVIL AND MECH. PRIOR TO FABRICATION AND CONSTRUCTION.
- 3.) SEE ARCH FOR DIMENSIONS NOT SHOWN.
- 4.) SEE ARCH AND MECH FOR ALL SLEEVES, PIPES, INSERTS AND EMBEDDED ITEMS.
- 5.) SEE ARCH AND MECH FOR SLOPES AND RECESSES.
- 6.) WP-1 DENOTES NEW 6X6 SOUTHERN PINE NO.2 WOOD POST, SEE SECTIONS.
- 7.) DENOTES EXTERIOR WOOD FRAMED WALL W/ 2X6 STUDS AT 12" O.C. MAX, (SOUTHERN PINE NO.2). SEE WOOD BEARING FRAMING WALL FRAMING ELEVATION ON SHEET S3.1 FOR ADDITIONAL INFORMATION.
- 8.) DENOTES WOOD SHEARWALL. SEE SCHEDULE ON S3.1.
- 9.) EXTERIOR WALL SHEATHING SHALL BE 1/2" EXTERIOR GRADE CDX PLYWOOD. ATTACH TO WOOD STUDS W/ 10d NAILS AT 6" O.C. AT PANEL EDGES AND 10d NAILS AT 12" O.C. IN FIELD, U.N.O. IN SHEARWALL SCHEDULE.
- 10.) DENOTES BRICK VENEER AND TIES, SEE ARCH FOR EXTENTS.
- 11.) C.J. DENOTES SLAB CONTROL JOINT, SEE TYPICAL DETAIL ON S3.1.
- 12.) (3) 2x6 STUD PACKS.
- 13.) USE SIMPSON ABU 66 W/ 5/8" x 5" LONG EPOXY ANCHOR SHIM. AS REQ'D.
- 14.) (2) 2x6 SHEAR WALL END STUD PACK (TYP.).
- 15.) T.E. DENOTES THICKENED EDGE, SEE SECTIONS.
- 16.) (3) 2x6 SHEAR WALL END STUD PACK (TYP.).

EXISTING STRUCTURAL MEMBERS:
THE GENERAL CONTRACTOR SHALL FIELD VERIFY LOCATIONS, DIMENSIONS, ELEVATIONS, AND CONDITION OF ALL PERTINENT EXISTING STRUCTURAL MEMBERS, (CONCEALED AND EXPOSED) PRIOR TO FABRICATION AND CONSTRUCTION. THE GENERAL CONTRACTOR SHALL NOTIFY THE ARCHITECT AND STRUCTURAL ENGINEER OF RECORD OF ANY DISCREPANCIES A MINIMUM OF 48 HOURS IN ADVANCE PRIOR TO CONSTRUCTION, TO ALLOW FOR MODIFICATION OF DESIGN PER UNFORSEEN FIELD CONDITIONS

NOTE: ALL DIMENSIONS SHOWN ARE TO FACE OF STUD

NOTE: THE GENERAL CONTRACTOR SHALL RETAIN THE SERVICES OF A LICENSED GEOTECHNICAL ENGINEER TO INSPECT FOUNDATION EXCAVATION AND PROVIDE RECOMMENDATIONS FOR SUBGRADE PREPARATION IN ORDER TO OBTAIN ASSUMED ALLOWABLE DESIGN BEARING PRESSURE OF 2000 PSF. GEOTECHNICAL RECOMMENDATIONS SHALL BE SUBMITTED TO THE ENGINEER OF RECORD FOR REVIEW AND TO MAKE NECESSARY ADJUSTMENTS TO THE FOUNDATION DESIGN AS REQUIRED.



Chick-fil-A

5200 Buffington Rd.
Atlanta Georgia,
30349-2998

Revisions:

Mark	Date	By
△		
△		
△		
△		

HAROLD G. HIGGENBOTHAM
PROFESSIONAL ENGINEER
AL. NO. 24263

HAROLD G. HIGGENBOTHAM, P.E.
ALABAMA LICENSE NO. 24263
1802 ROBIN RD.
ORLANDO, FLORIDA 32803
PHONE 407 286 1787
FAX 407 286 2281

STORE
DAUPHIN STREET
FSU S97-100

3244 DAUPHIN ST.
MOBILE, AL 36606

SHEET TITLE
FOUNDATION
PLAN

VERSION: 2017-042
ISSUE DATE: 11/14/17

Job No. : 17.0181
Store : 01350
Date : 01/2018
Drawn By : RED
Checked By : HGH

Sheet

S.I.