

Technical data

Pump name

DWO 150

| | | |
|----------|--|-----------|
| Customer | Date 03-April-2018 | Company |
| Contact | Item no. 1.1 | Issued by |
| Phone | Project | Phone |
| E-mail | Project ID EBARA Pump Selector-2121165 | E-mail |

Requested data

| | | | | |
|---|------------------------------|-------------------|-----------------------|--------------|
| 1 | Pump type | CENTRIFUGAL PUMPS | Fluid | Water, clean |
| 2 | Number of pumps / Reserve | 1 / 0 | Liquid temperature °C | 20 |
| 3 | Flow m³/h | 0 | Kin. viscosity mm²/s | 1 |
| 4 | Head m | 0 | Vapour pressure bar | 0.022 |
| 5 | Static head m | 0 | PH value | 7 |
| 6 | Inlet pressure bar | 0.1 | Density kg/dm³ | 1 |
| 7 | Available system NPSH | 0 | Solids Weight % | 0 |
| 8 | Environmental temperature °C | 20 | Altitude m | 1000 |

Pump

| | | | | |
|----|---------------------------|--------------------------------|--------------------------------------|-----------------|
| 9 | Pump name | DWO 150 | Frequency Hz | 50 |
| 10 | Design | CENTRIFUGAL PUMPS | Installation type | STANDARD |
| 11 | Manufacturer | EPE | Impeller | Max. mm 88 |
| 12 | Speed 1/min | 2800 | Diameter | Designed mm 88 |
| 13 | No. of Stage | 1 | | Min. mm 88 |
| 14 | Connection Suction side | | Flow | Operating m³/h |
| 15 | Connection Discharge side | | | Max- m³/h 33 |
| 16 | Max Working Pressure bar | 8 | | Min- m³/h 6 |
| 17 | Shut-off head bar | 0.96 | Head | Operating m |
| 18 | Total weight kg | See the table of "Dimensions". | | - (Qmax.) m 5.1 |
| 19 | Shaft power kW | | | - (Qmin.) m 9.5 |
| 20 | | | Max. Shaft Power at max. impeller kW | 1.03 |
| 21 | Required NPSH m | | Efficiency % | |

Materials

| | | | | |
|----|----------|----------|--|--|
| 22 | Impeller | AISI 304 | | |
| 23 | Casing | AISI 304 | | |
| 24 | Shaft | AISI 304 | | |
| 25 | | | | |
| 26 | | | | |
| 27 | | | | |

Motor

| | | | | |
|----|----------------------|------------------------------|--------------------|-----|
| 28 | Manufacturer | EPE Standard | Insulation class | F |
| 29 | Type | TEFC_DWO 150_400_Three Phase | Phases | 3~ |
| 30 | Specific design | IE3 / 50 Hz / Pole pairs 1 | Frame size | |
| 31 | Rated power kW | 1.1 | Weight kg | 0 |
| 32 | Number of poles | 2 | Electric voltage V | 400 |
| 33 | Speed 1/min | 2800 | Electric current A | 3.3 |
| 34 | Degree of protection | IP 55 | | |
| 35 | | | | |

Remarks

Performance curve Pump name DWO 150

| | | |
|----------|--|-----------|
| Customer | Date 03-April-2018 | Company |
| Contact | Item no. | Issued by |
| Phone | Project | Phone |
| E-mail | Project ID EBARA Pump Selector-2121165 | E-mail |

Requested data

| | | | |
|---|-------------|------|---|
| 1 | Flow | m³/h | 0 |
| 2 | Head | m | 0 |
| 3 | Static head | m | 0 |

Pump

| | | | | |
|-------------------|-------------|-----------------|-------|-------|
| Operating Flow | m³/h | Frequency | Hz | 50 |
| Operating Head | m | Number of poles | 2 | |
| Impeller Diameter | Designed mm | 88 | Speed | 1/min |

Test standard: ISO 9906:2012 - Grade3B

Water, clean [100%] ; 20°C; 0.9983kg/dm³; 1mm²/s

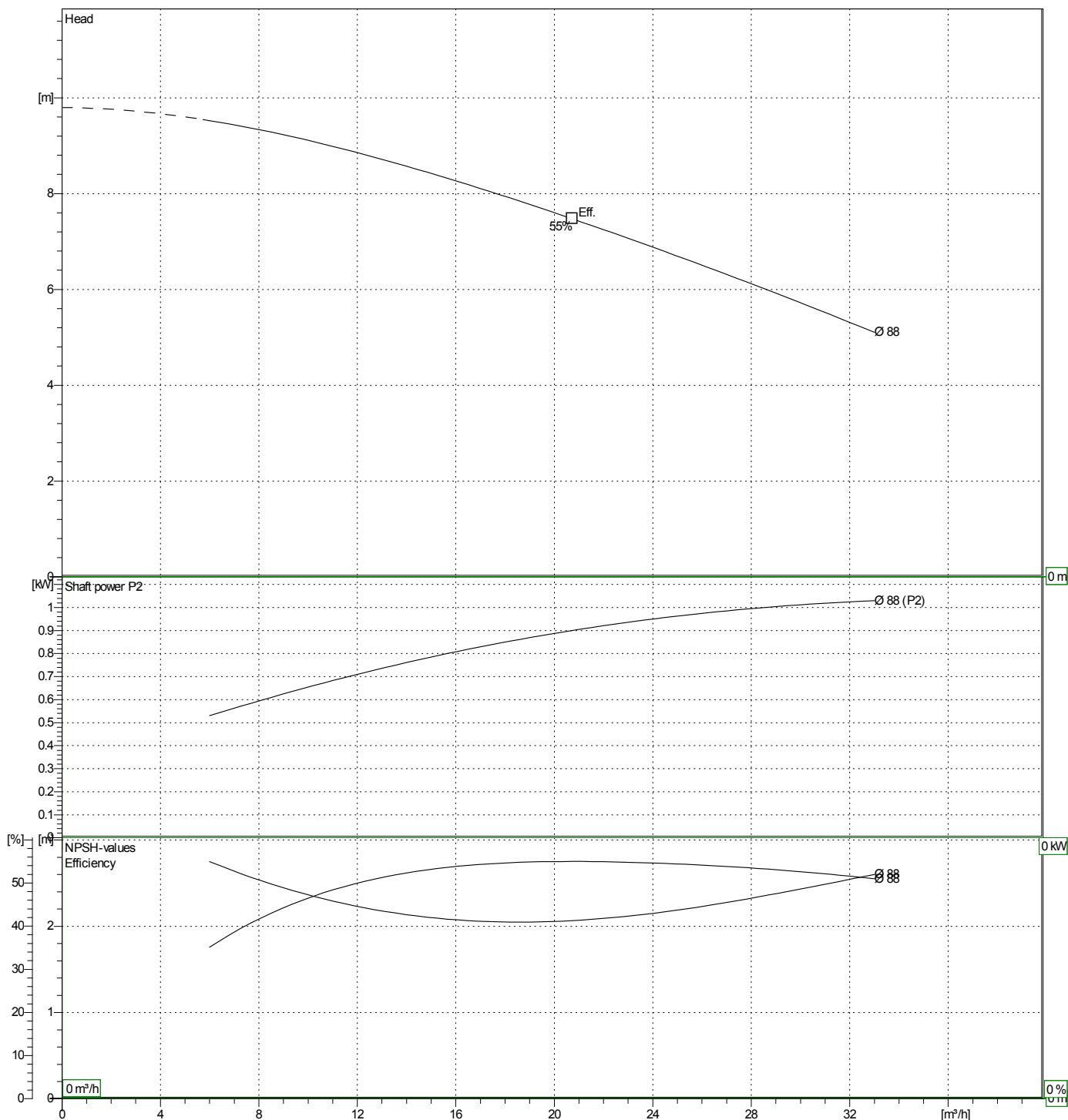

Dimensions

Pump name DWO 150

| | | |
|----------|--|-----------|
| Customer | Date 03-April-2018 | Company |
| Contact | Item no. | Issued by |
| Phone | Project | Phone |
| E-mail | Project ID EBARA Pump Selector-2121165 | E-mail |

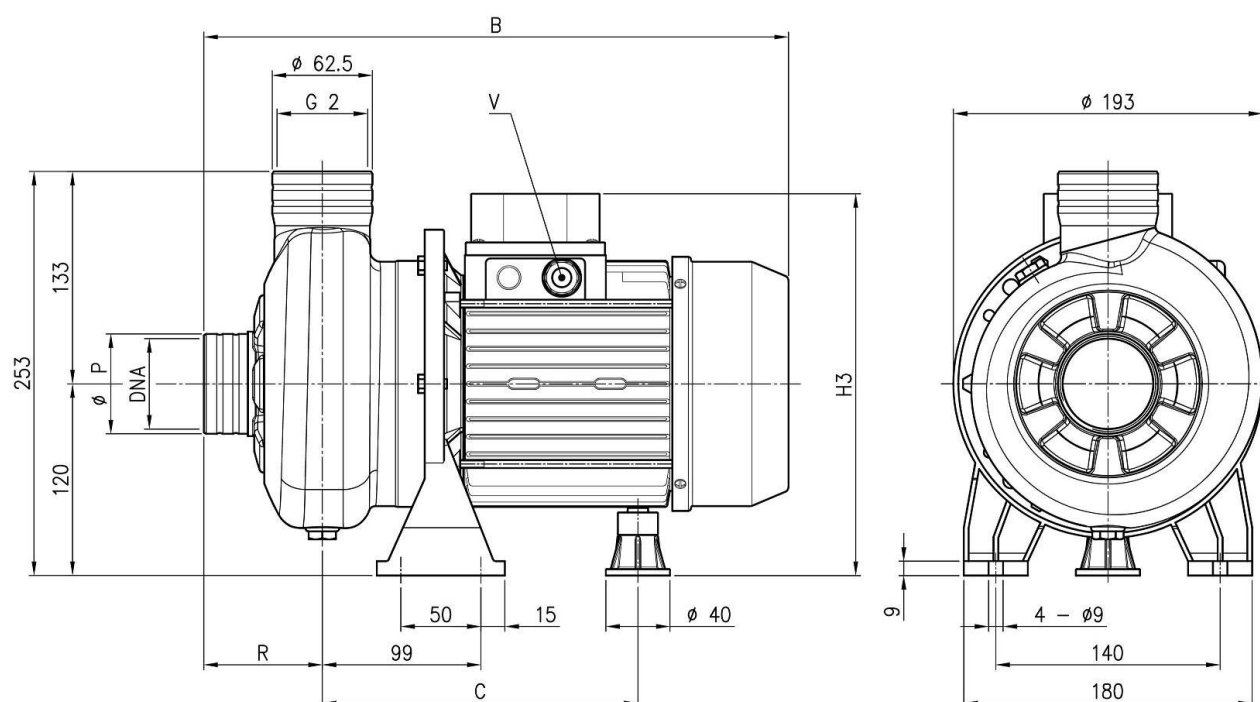

| Dimensions in mm | | | | | | | |
|------------------|------------|---------|--|--|--|--|--|
| 1 | B | 390 | | | | | |
| 2 | C | 197 | | | | | |
| 3 | Dia P | 62.5 | | | | | |
| 4 | DNA | G 2 | | | | | |
| 5 | R | 74 | | | | | |
| 6 | V | M20X1.5 | | | | | |
| 7 | Weight P&M | 15.4 kg | | | | | |

(1/3) Construction

Pump name DWO 150

| | | |
|----------|--|-----------|
| Customer | Date 03-April-2018 | Company |
| Contact | Item no. | Issued by |
| Phone | Project | Phone |
| E-mail | Project ID EBARA Pump Selector-2121165 | E-mail |

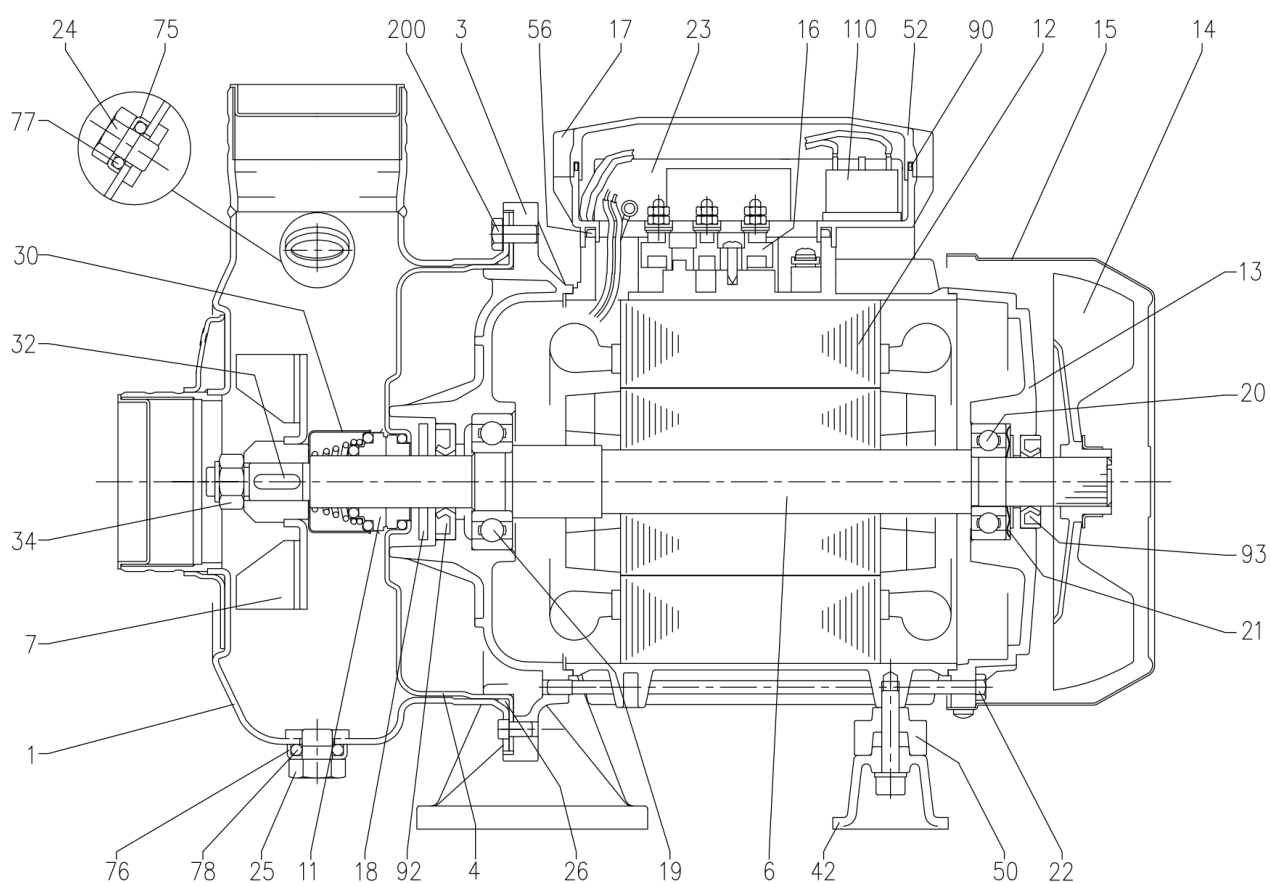

(2/3) Construction

Pump name DWO 150

| | | |
|----------|--|-----------|
| Customer | Date 03-April-2018 | Company |
| Contact | Item no. | Issued by |
| Phone | Project | Phone |
| E-mail | Project ID EBARA Pump Selector-2121165 | E-mail |

| N° | PART NAME | MATERIAL | Q.TY |
|-----|-------------------------------|----------------------------|------|
| 1 | Casing | AISI 304 | 1 |
| 3 | Motor bracket | Aluminium | 1 |
| 4 | Casing cover | AISI 304 | 1 |
| 6 | Shaft with rotor | AISI 304 (Wet extention) | 1 |
| 7 | Impeller | AISI 304 | 1 |
| 11 | Mechanical seal [3] | Carbon/Ceramic/NBR | 1 |
| 12 | Motor frame with stator | - | 1 |
| 13 | Motor cover | Aluminium | 1 |
| 14 | Fan | PP | 1 |
| 15 | Fan cover | Fe P04 Zincate | 1 |
| 16 | Terminal box | - | 1 |
| 17 | Terminal box cover [2] | Aluminium | 1 |
| 18 | Splash ring | NBR | 1 |
| 19 | Pump side ball bearing | - | 1 |
| 20 | Fan side ball bearing | - | 1 |
| 21 | Adjusting ring | Steel C70 | 1 |
| 22 | Tie rod | Fe 420 Zincate | 4 |
| 23 | Capacitor [1] | - | 1 |
| 24 | Priming plug | AISI 303 | 1 |
| 25 | Drain plug | AISI 303 | 1 |
| 26 | O-ring [4] | NBR/FPM/EPDM | 1 |
| 30 | Mechanical seal protection | AISI 304 | 1 |
| 32 | Key | AISI 316 | 1 |
| 34 | Impeller nut | AISI 304 | 1 |
| 42 | Motor support | Aluminium | 1 |
| 50 | Spacer | - | 1 |
| 52 | Terminal box [1] | PP | 1 |
| 56 | Box gasket | NBR | 1 |
| 75 | Washer | AISI 304 | 1 |
| 76 | Washer | AISI 304 | 1 |
| 77 | O-ring [4] | NBR/FPM/EPDM | 1 |
| 78 | O-ring [4] | NBR/FPM/EPDM | 1 |
| 90 | Terminal box cover gasket [1] | NBR | 1 |
| 92 | Lip seal | - | 1 |
| 93 | Lip seal | - | 1 |
| 110 | Protector [1] | - | 1 |
| 200 | Screw | Stainless steel A2 UNI7323 | 6 |

[1] Only for Single phase

[2] Only for Three phase

[3] See **CONSTRUCTION 3**

[4] FPM for H-HS-HW-HSW-Q1AVGG
EPDM for AQ1EGG-VAEGG-Q1U3EGG-U3BEGG
NBR only for Standard version

(3/3) Construction

Pump name DWO 150

| | | |
|----------|--|-----------|
| Customer | Date 03-April-2018 | Company |
| Contact | Item no. | Issued by |
| Phone | Project | Phone |
| E-mail | Project ID EBARA Pump Selector-2121165 | E-mail |

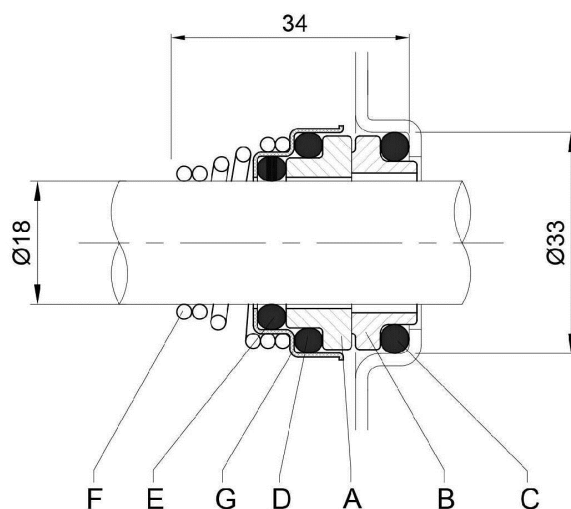

| REF | PART NAME | MATERIAL Standard |
|-----|----------------------|----------------------|
| A | Rotary seal ring | Ceramic |
| B | Stationary seal ring | Carbon graphite |
| C | O-ring | NBR |
| D | O-ring | NBR |
| E | O-ring | NBR |
| F | Self driving spring | AISI 316 |
| G | Frame | AISI 304 |